

AUTOGARD SERIES 320

STANDARD HUB

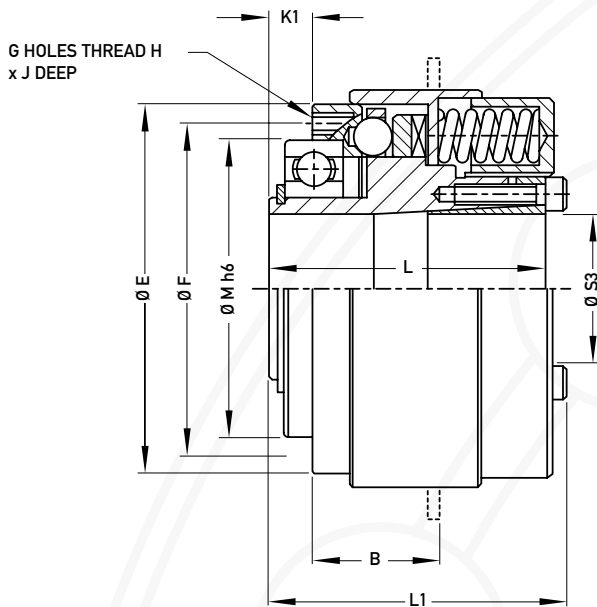

Type 1

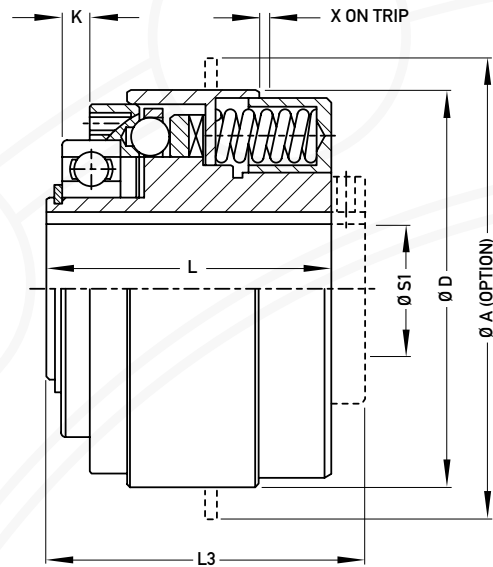

Type 2

Technical Data - Type 1 and Type 2

Size		01	0	1	2	3	4
Torque - Nm	Minimum	5	10	20	40	80	150
	Maximum	50	100	200	400	700	1500
Weight - Kg		1.00	1.91	2.89	4.47	7.41	12.95
Mass Moment of Inertia	Hub Side	0.0004	0.0009	0.0019	0.0044	0.0094	0.0257
	Flange Side	0.0001	0.0005	0.0010	0.0020	0.0040	0.0109

Dimensional Data (mm) - Type 1 and Type 2

Size		01	0	1	2	3	4
Bore (S3) - Clamped Collar	Minimum	10	15	22	32	35	42
	Maximum	20	28	35	45	55	65
Bore (S1) - Keyed Hub	Maximum	20	23	32	40	50	58
A		80	100	116	140	160	190
B		21	28	33	38	42	49
D		68	84	100	120	132	166
E		63.6	78.7	93.6	111	127	157
F		56	71	85	100	116	144
G		8	8	8	8	8	8
H		M4	M5	M6	M6	M8	M10
J		6	8	10	12.7	12.7	18
K		5	7	7	8	8	8
K1		8	11	12	12	16	16
L		47	60	71	84	95	110
L1		50	65	77	90	101	118
L3		52	68	80	95	105	122
M		47	62	75	90	100	115
X		1.2	1.6	1.7	2.2	2.4	2.8

- 1) The Drive Medium must be bored to suit dimension "M". Clutches may be ordered complete with Drive Medium (V-Belt Pulleys, Timing Pulleys etc.)
- 2) Weights and Inertia values are for unbored units.